

SEALED TOGGLE SWITCHES

T1
SEALED
TOGGLES

PANEL SEALED PER MIL-PRF-83731

3-Position, 4 Pole, Lever Lock

Basic Switches: Per MIL-PRF-8805/101
Enclosure: Sealed per MIL-DTL-83731
Rating: 5 amps Resistive @ 28VDC
 1 amp Inductive @ 28VDC
 1 amp Lamp @ 28VDC
 2 amps Motor @ 28VDC

Action: Maintained
Cap: Nylon
Handle: Stainless steel

*Lever Lock configurations A thru P available.



T1-0216*

T1-0185*

2-Position, 3 Pole, Lever Lock

Basic Switches: Per MIL-PRF-8805/109
Enclosure: Sealed per MIL-DTL-83731
Rating: 1 amp Resistive @ 28VDC
 0.5 amp Inductive @ 28VDC

Action: Maintained-momentary
Handle: Stainless steel, dull nickel plate
Cap, Handle: Brass, dull nickel
Bushing: Stainless steel with black oxide finish

T1-0175*

*Lever Lock configurations D, F and G available.



3-Position, 8 Pole, Lever Lock

Basic Switches: Per MIL-PRF-8805/101
Enclosure: Sealed per MIL-DTL-83731
Operating Force: 6.0 lbs. max
Rating: 5 amps Resistive @ 28VDC
 1 amp Inductive @ 28VDC
 1 amp Lamp @ 28VDC
 2 amps Motor @ 28VDC

Action: Maintained
Cap, Handle: Brass, dull nickel plate
Handle: Stainless steel

T1-0210*

*Lever Lock configurations A thru P available.



2-Position, 3 Pole, Lever Lock

Basic Switches: Per MIL-PRF-8805/101
Enclosure: Sealed per MIL-DTL-83731
Operating Force: 6.0 lbs. max
Rating: 5 amps Resistive @ 28VDC
 1 amp Inductive @ 28VDC
 1 amp Lamp @ 28VDC
 2 amps Motor @ 28VDC

Action: Maintained
Cap, Handle: Brass, dull nickel plate
Handle: Stainless steel

T1-0214*



2-Position, 2 Pole

Toggle Seal: Per MIL-DTL-83731
Basic Switch: Per MIL-PRF-8805/109 (except terminals)
Enclosure: Sealed per MIL-DTL-83731
Operating Force: 2.0 lbs. to 5.0 lbs. max
Rating: 1 amp Resistive @ 28VDC
 0.5 amp Inductive @ 28VDC

Action: Maintained-maintained
Bat, Handle, Bushing & Bracket: Stainless steel

T1-0051-1



2-Position, 3 Pole, Lever Lock

Basic Switches: Per MIL-PRF-8805/101
Enclosure: Toggle seal per MIL-DTL-83731
Operating Force: 5.0 lbs. max
Rating: 150mA Resistive @ 28VDC
Mechanical Life: 100,000 cycles
Action: Maintained-maintained
Handle: Stainless steel, dull nickel plate
Cap, Handle: Brass, dull nickel plate
Bushing & Bracket: Stainless steel

T1-0081D*

*Lever Lock configurations D, F and G available.



3-Position, 8 Pole, "T" Lever Lock

Basic Switch: Per MIL-PRF-8805
Enclosure: Sealed per MIL-DTL-83731
Rating: 5 amps Resistive @ 28VDC
 1 amp Inductive @ 28VDC
 1 amp Lamp @ 28VDC
 2 amps Motor @ 28VDC

Action: Maintained
Bushing, Cap & Handle: Stainless steel

T1-0215*

*Lever Lock configurations A thru P available.



Stainless Steel/Silicone Rubber Washer

Stainless steel cup washer with silicone rubber seal assures proper watertight panel seal. Mounts behind panel.
 Approved to MIL-DTL-5423/16. Designed for sealing 15/32" bushing with keyway.

OTTO P/N: 710196
MIL P/N: M5423/16-01

Thickness of bushing seal is reduced to 0.080" when mounted to panel.

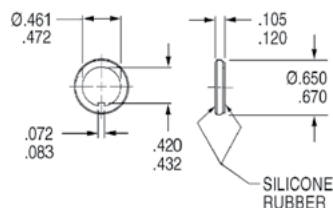

Lever Lockout Configuration Codes

Figures A thru P are schematics to illustrate lockout configurations and momentary positions. They do not represent details of construction.

- A Locked in all three positions
- B Locked in Center and Keyway Side position
- D Locked out of Center position
- E Locked in Center position
- F Locked in Opposite Keyway position
- G Locked in Keyway Side position
- H Locked out of Center and Keyway Side Position
- J Locked out of Center and Opposite Keyway position
- K Locked in Center and Opposite Keyway position
- L Locked out of Keyway Side position
- M Locked out of and into Opposite Keyway position
- N Locked out of Opposite Keyway position
- P Locked out of and into Keyway Side position

